

Introduction

The TB-03 is a sound module that uses cutting-edge modeling technology to faithfully model the Roland TB-303 which went on sale in 1982. In addition to its compact size, it allows battery-powered operation and contains a small speaker. You'll be able to enjoy full-fledged TB-303 sound anywhere.

Using the TB-03 in conjunction with the DK-01 Boutique Dock (accessory) For installation/removal/angle adjustment, refer to the DK-01's Owner's Manual.

Playing the TB-03 via MIDI or USB

You can also play the TB-03 via MIDI or USB. For details, refer to "Connecting Your Equipment"

Connecting Your Equipment

Prevent malfunction and equipment failure, always turn down the volume, and turn off all the units before making any connections.

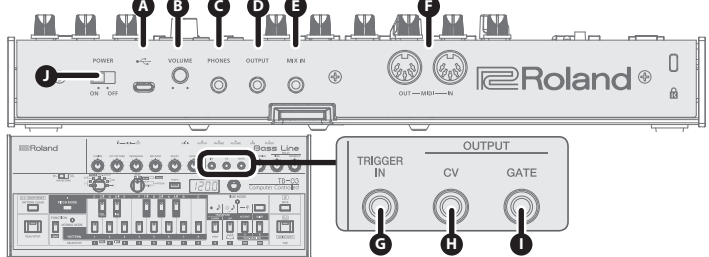

Micro USB (Type-C) port Use a commercially available USB 2.0 cable (A-MicroB) to connect this port to your computer.

VOLUME knob Adjusts the volume.

PHONES jack Connect headphones (sold separately) here.

OUTPUT jack Connect this jack to your amp or monitor speakers.

MIX IN jack This is the audio input jack. Sound from the connected device is output from the OUTPUT jack and PHONES jack.

MIDI connectors You can synchronize the TB-03 with other MIDI device by using a commercially available MIDI cable to make connections.

TRIGGER IN jack *1 You can use a mini-plug (mono) cable to connect this to a device that's equipped with a TRIGGER OUT jack (such as the TR-09). If a plug is inserted into this jack, the TB-03 is disconnected from its internal clock, so that its steps advance each time a trigger pulse is received at this jack.

CV OUTPUT jack *1 You can use a mini-plug (mono) cable to connect this jack to an analog synthesizer that's equipped with CV/GATE input jacks.

GATE OUTPUT jack *1 This jack outputs note-on/off signals. During note-on, +12 V is output. This jack outputs note-on/off signals. During note-on, +12 V is output.

*1 Not a "stereo mini-plug" cable; it won't work correctly.

Turning the Power On

POWER switch This turns the power on/off. After you've made connections correctly, be sure to turn on the power in the order of the TB-03 first, and then the connected system.

When you press the [FUNCTION] button, the lit or blinking state of the numeric buttons indicates the current measure number.

Setting the tempo In track play/write mode, the display shows the tempo value, but you can press the [TEMPO] button to make the tempo appear for three seconds.

Setting the shuffle Refer to "Pattern Playback" - "Setting the shuffle"

Indication of D.C. (Da Capo/last measure) When playback reaches the end of the measure that is specified as D.C., playback returns to the first measure of the track.

Segno indication If you press the [D.S.] (Da Segno) button during playback, the playback jumps to the measure that is specified as (Segno).

Viewing the transpose setting Regardless of whether you are playing back or stopped, pressing the [PITCH MODE] button makes a keyboard button light up to indicate the transpose setting of the current measure.

Pattern Write (TB-03 Original Mode)

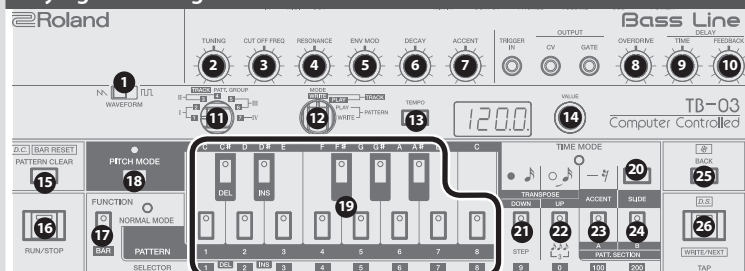

Adjusting the Sound

Table with 2 columns: Controller and Explanation. Lists parameters like WAVEFORM, TUNING, CUT OFF FREQ, RESONANCE, ENV MOD, DECAY, ACCENT, OVERDRIVE, DELAY TIME, and FEEDBACK.

Pattern Playback

What are patterns and tracks? A "pattern" is performance data that divides a measure into 16 steps. The TB-03 has 96 "patterns" and seven "tracks" in which patterns can be arranged.

Selecting PATTERN PLAY mode

1. Turn the [MODE] knob to set to "PATTERN PLAY"

Selecting a pattern

1. Use the [PATT. GROUP] knob to select a pattern group (I-IV). Pattern group "I" is selected regardless of whether you select numbers 1 or 2.

Playing patterns consecutively

When selecting a pattern, you can select multiple patterns by pressing two buttons at the same time. The patterns you've selected will play consecutively. The currently-playing pattern blinks.

Playing a pattern

1. Press the [RUN/STOP] button to play/stop a pattern.

Pattern transpose

1. Hold down the [PITCH MODE] button and then press the [KEYBOARD] button.

Setting the tempo

In pattern play mode, the display shows the tempo. You can press the [TEMPO] button to see the two digits of the tempo value below the decimal point.

Setting the shuffle

If you long-press the [TEMPO] button, the shuffle value is displayed. You can set the shuffle setting by holding down the [TEMPO] button and turning the [VALUE] knob.

Temporarily changing the number of steps in a pattern Hold down the [TIME MODE] button and turn the [VALUE] knob to change the number of steps in the pattern (1-16).

What is "step"? Each pattern is divided into 16 grid locations called "steps." One step is a 16th note long.

Checking the time 1. Press the [TIME MODE] button so it's lit. 2. Press the [TAP] button to check the data of each note.

Track Write

Selecting TRACK WRITE mode

1. Turn the [MODE] knob to set to "TRACK WRITE"

Selecting a track

1. Use the [TRACK] knob to select a track (1-7). The display shows the measure number.

The pattern group that can be written to a track The pattern group that can be written to a track is the group that is selected by the [TRACK] knob.

Writing a track

1. Use the [BAR RESET] button to return to measure 1. 2. Press the [RUN/STOP] button. Loop-playback occurs during track write. The pattern that plays at this time is the pattern that was written into measure 1.

Making Corrections

If you entered something by mistake, you can correct it as follows. 1. Turn the [MODE] knob to set to "TRACK WRITE". 2. Recall the measure number as described in "Recalling a measure number".

Delete

Here's how to delete one measure from the patterns in the track. 1. Turn the [MODE] knob to set to "TRACK WRITE".

Insert

You can insert patterns into the track. 1. Turn the [MODE] knob to set to "TRACK WRITE". 2. As described in "Recalling a measure number", move to the measure at which you want to insert.

Deleting a measure

1. Hold down the [FUNCTION] button and press the [DELETE] (C #) button. 2. Press the [RUN/STOP] button.

Viewing the transpose setting

Regardless of whether you are playing back or stopped, pressing the [PITCH MODE] button makes a keyboard button light up to indicate the transpose setting of the current measure.

Pattern Write (TB-03 Original Mode)

Original mode and step recording mode The TB-03 has two pattern write modes. "Original mode" reproduces the pattern write operation of the TB-303, and "step recording mode" is newly added on the TB-03.

Selecting PATTERN WRITE mode

1. Turn the [MODE] knob to set to "PATTERN WRITE"

Selecting a pattern

Refer to "Pattern Playback" - "Selecting a pattern"

Setting the tempo

In pattern write mode, the display shows the step number, but you can press the [TEMPO] button to make the tempo appear for three seconds. While the tempo is shown, you can press the [TEMPO] button to see the two digits of the tempo value below the decimal point.

Setting the shuffle

Refer to "Pattern Playback" - "Setting the shuffle"

Clearing a pattern

1. Hold down the [PATTERN 1]-[8] button that you want to clear, and press the [PATTERN CLEAR] button.

To use a triplet grid

By default, each step is a 16th note, but by holding down the [FUNCTION] button and pressing the [TRIPLET] button you can use a triplet grid (each step is an 8th note triplet).

Changing the number of steps in a pattern

1. Hold down the [FUNCTION] button and press the [STEP] button the number of times that you want to specify. Example: If you want there to be eight steps, press the button eight times.

Entering the pitches

In TB-03 original mode, you enter the notes of a pattern using separate operations to specify the pitch and the timing. Enter the pitches first. 1. Press the [PITCH MODE] button so it's lit.

The display shows a number (1, 2, 3, ...) in the order of the notes that you enter; you can use the [VALUE] knob to select a number.

Entering octave-up or octave-down pitches

Shift the octave up or down by pressing (or holding down) [TRANSPOSE UP] or [TRANSPOSE DOWN], then press a [KEYBOARD] button (Lit: ± 1 octave, Blink: ± 2 octaves).

Checking the pitches

1. Press the [PITCH MODE] button so it's lit. 2. Press the [TAP] button to check the pitch of each note.

Entering the timing

1. Press the [TIME MODE] button so it's lit. You're in time entry mode. 2. Use the note selector [(note), (tie), and (rest)] buttons to enter the timing.

The display shows the step number; you can use the [VALUE] knob to select the step.

Checking the time

1. Press the [TIME MODE] button so it's lit. 2. Press the [TAP] button to check the data of each note.

Entering accents and slides

1. Press the [PITCH MODE] button so it's lit. 2. Press the [TAP] button to check each note. If you want to add an accent, hold down the [TAP] button and press the [ACCENT] button.

Tap Write (Entering Timing in Real Time)

Before you continue, complete the steps for "Entering the pitches". 1. Press the [FUNCTION] button. 2. Press the [RUN/STOP] button. 3. Press the [PATTERN CLEAR] button.

Pattern Write (Step Recording Mode)

This is the step recording mode that was newly added on the TB-03. You'll enter notes, rests, accents, and slides/ties while watching the step number in the display.

Select "step recording mode" in system settings

1. Hold down the [FUNCTION] button and turn the [VALUE] knob to select "Step". 2. Release the [FUNCTION] button. 3. Use the [VALUE] knob to select "STEP". 4. Press the [FUNCTION] button.

Selecting PATTERN WRITE mode

1. Turn the [MODE] knob to set to "PATTERN WRITE"

Selecting a pattern

Refer to "Pattern Playback" - "Selecting a pattern"

Clearing a pattern

1. Hold down the [PATTERN 1]-[8] button that you want to clear, and press the [PATTERN CLEAR] button.

Step recording

1. Press the [PITCH MODE] button so it's lit. You're in step recording entry mode. 2. Use the buttons and the [VALUE] knob to enter performance data into the steps.

Playing patterns consecutively

When selecting a pattern, you can select multiple patterns by pressing two buttons at the same time. The patterns you've selected will play consecutively. The currently-playing pattern blinks.

When you press the [FUNCTION] button, the lit or blinking state of the numeric buttons indicates the current measure number.

Table with 2 columns: Controller and Explanation. Lists parameters like VALUE knob, Keyboard buttons, [DOWN] button, [UP] button, [TIME MODE] button, [TIME MODE] + [UP] button, [TIME MODE] + [ACCENT] button, [ACCENT] button, [SLIDE] button.

3. To exit the step recording, press the [FUNCTION] button. For details on the following operations, refer to "Pattern Write (TB-03 Original Mode)".

Turning the Power On This turns the power on/off. After you've made connections correctly, be sure to turn on the power in the order of the TB-03 first, and then the connected system.

When you press the [FUNCTION] button, the lit or blinking state of the numeric buttons indicates the current measure number.

Setting the tempo In track play/write mode, the display shows the tempo value, but you can press the [TEMPO] button to make the tempo appear for three seconds.

Setting the shuffle Refer to "Pattern Playback" - "Setting the shuffle"

Indication of D.C. (Da Capo/last measure) When playback reaches the end of the measure that is specified as D.C., playback returns to the first measure of the track.

Segno indication If you press the [D.S.] (Da Segno) button during playback, the playback jumps to the measure that is specified as (Segno).

Viewing the transpose setting Regardless of whether you are playing back or stopped, pressing the [PITCH MODE] button makes a keyboard button light up to indicate the transpose setting of the current measure.

Main Specifications Roland TB-03: Bass Line

Table with 2 columns: Specification and Detail. Lists Power Supply, Current Draw, Dimensions, Weight, and Accessories.

System Settings

1. Hold down the [FUNCTION] button and turn the [VALUE] knob to select a parameter. When you release the [FUNCTION] button, the parameter is finalized and the value is displayed.

Table with 4 columns: Display, Parameter, Value, and Explanation. Lists settings for MIDI Channel, MIDI Clock Source, Auto Off, LED Demo, Step Recording Mode, Overdrive Type, Delay Type, and Delay Tempo Sync.

Restoring the Factory Settings (Factory Reset)

Here's how to return the TB-03 to its factory-set state. 1. While holding down the [RUN/STOP] button, turn on the power. 2. Press the [TAP] button to check the factory reset.

Data Backup/Restore

Back up 1. Connect your computer to the TB-03's USB port via USB cable. 2. While holding down the [RUN/STOP] button, turn on the power.

Restore 1. As described in the procedure for "Backup" Step 1-3, open the "TB-03" drive on your computer.

This document explains the specifications of the product at the time that the document was issued. For the latest information, refer to the Roland website.